

Results Driven Retail SolutionsSM

Barnard Commercial
Real Estate

The Union

304 NE Multnomah Street, Portland OR 97232

View Online
With Video
Tours:



The Union is a brand new mixed use apartment and retail building located at the intersection of MLK Boulevard and Multnomah Street. Centrally located in the inner NE pocket that is sandwiched between the Moda Center, the Oregon Convention Center and the developments that are part of the new Lloyd district. The Convention Center Hotel, Hyatt Regency, will soon be located adjacent, adding 600 rooms with additional amenities and Hotel Eastlund is across the street to the East. Starbucks is currently located in the building and Burgerville is the neighbor to the North. Be a part of this high density, high traffic bustling corner of the new East Portland downtown area.



Available:

Suite 1—1,520 SF

Suite 3—1,390 SF

\$28.00 SF/Year, NNN

Location Highlights:

- Population: 22,700 within 1 mile
- Average Daily Traffic: 22,511 cars per day on this stretch of MLK
- Hyatt Regency—600 Rooms (2018) & Hotel Eastlund—168 rooms
- 185 Luxury apartment units
- Moda Center—5 minute walk
- Oregon Convention Center—3 minute walk
- Lloyd District—6 minute walk
- Convention Center Max Station—lines blue, green and red
- Bus routes 6, 8, 77, 157



503.675.0900 | Email: info@barnardcommercial.com | www.barnardcommercial.com

Mail: 6650 SW Redwood Lane Suite 330, Portland OR 97224

All information contained herein was obtained from sources deemed reliable. No guarantee is made with respect to accuracy. Specifications subject to change without notice.

The Union

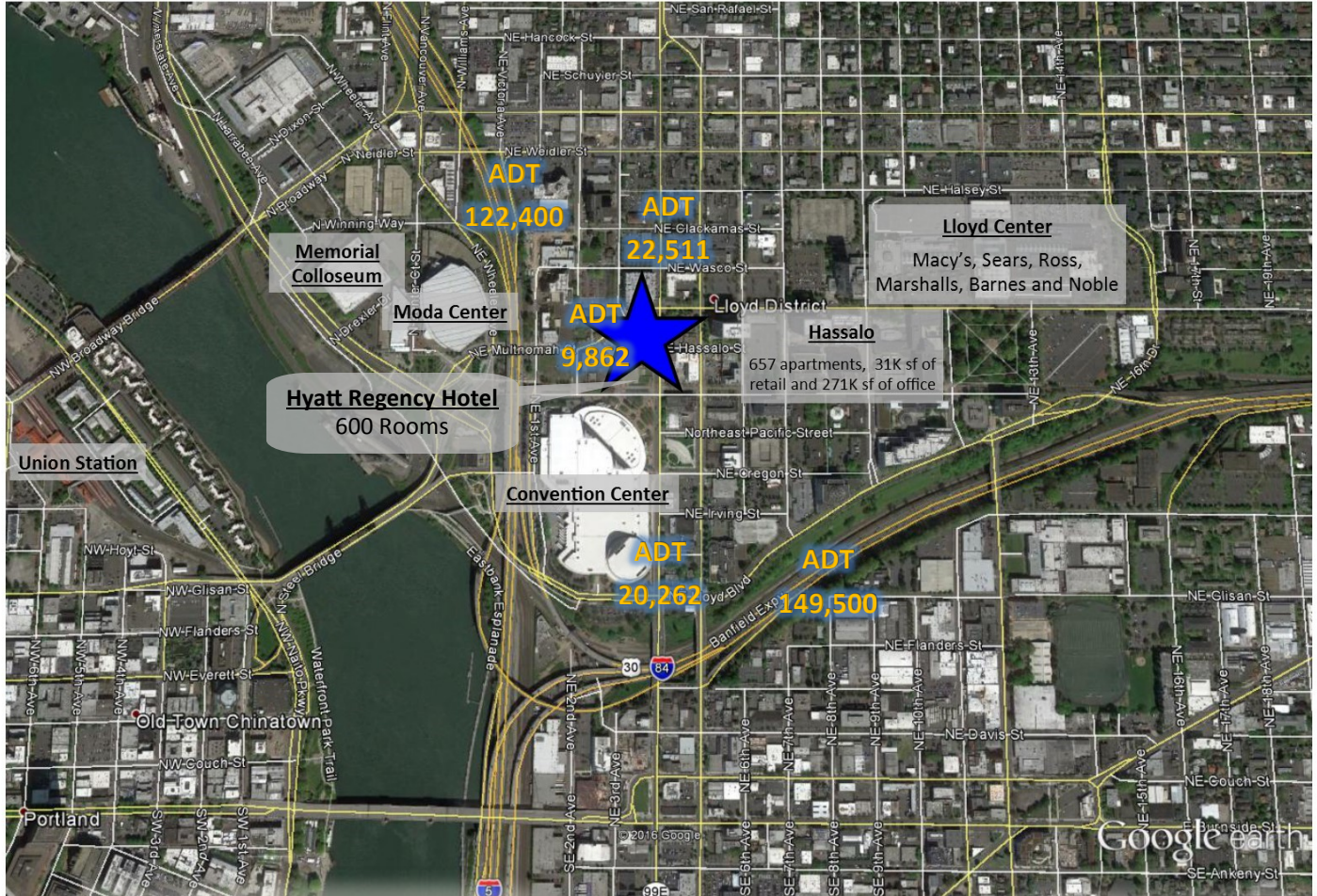

Proximity to local attractions



Demographics

2015 Estimate	1 Mile	3 Mile	5 Mile
Population:	22,700	202,524	394,588
Average HH Income:	\$59,350	\$73,249	\$74,527

503.675.0900 | Email: info@barnardcommercial.com | www.barnardcommercial.com

Mail: 6650 SW Redwood Lane Suite 330, Portland OR 97224

Results Driven Retail SolutionsSM

Barnard Commercial
Real Estate

The Union

Suite 3—1,390 SF

Adjacent to Starbucks, tall ceilings, double door entry



Suite 1—1,520 SF

Facing Multnomah and the Moda Center, tall ceilings, double door entry



503.675.0900 | Email: info@barnardcommercial.com | www.barnardcommercial.com

Mail: 6650 SW Redwood Lane Suite 330, Portland OR 97224

All information contained herein was obtained from sources deemed reliable. No guarantee is made with respect to accuracy. Specifications subject to change without notice.

Results Driven Retail Solutions SM

Barnard Commercial
Real Estate

The Union

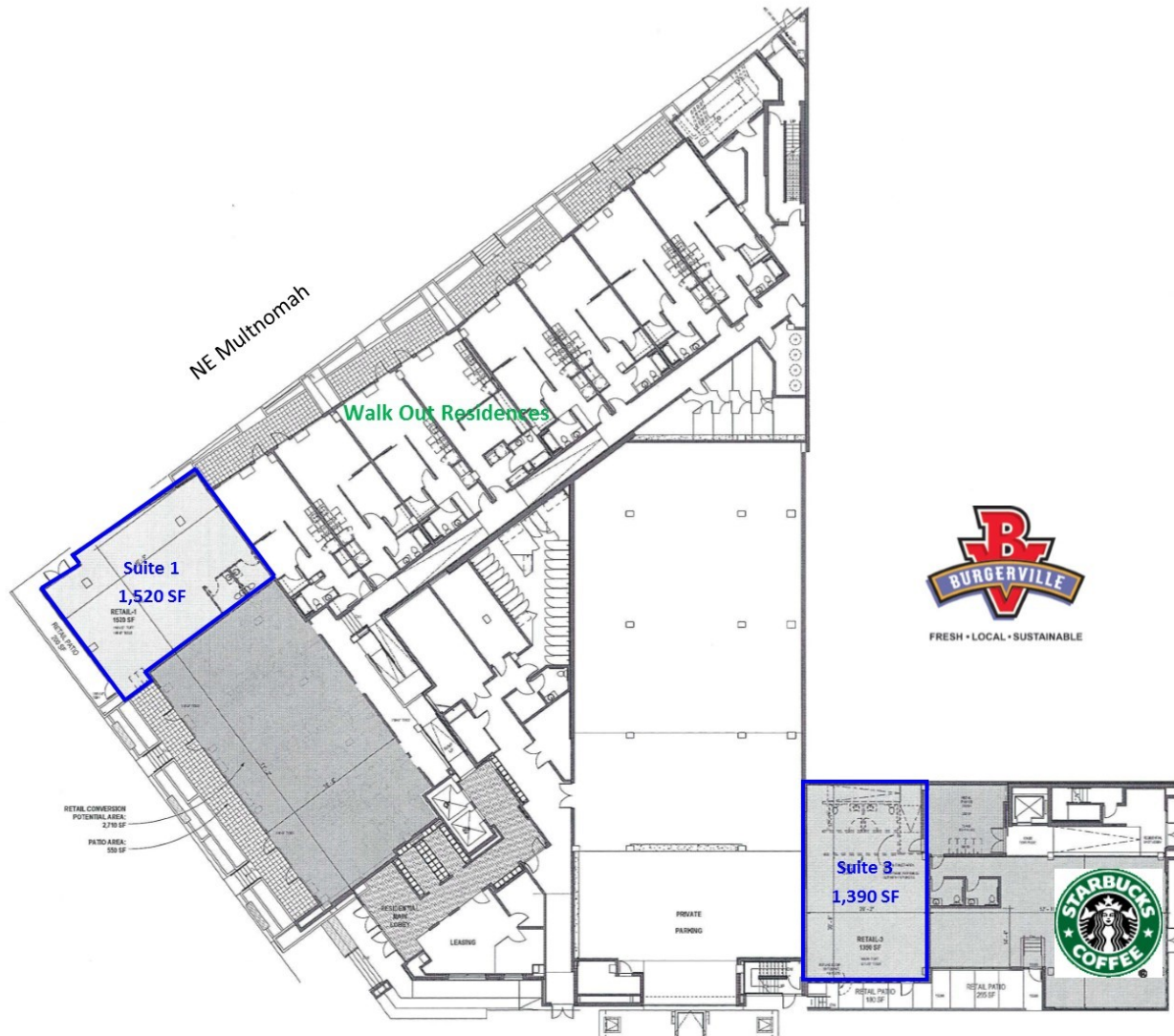

503.675.0900 | Email: info@barnardcommercial.com | www.barnardcommercial.com
Mail: 6650 SW Redwood Lane Suite 330, Portland OR 97224

All information contained herein was obtained from sources deemed reliable. No guarantee is made with respect to accuracy. Specifications subject to change without notice.